

Fungicidal activity + anti-itching ingredients and antifungal ingredients

ブテナロック[®]Vα 液

Butenalock[®]Vα Eki

Therapeutic drug for athlete's foot/ringworm that contains butenafine hydrochloride

Product features/characteristic

- Athlete's foot/ringworm are diseases caused by infestation of mold (fungus) called Trichophyton in the corneal layer of the skin surface. Trichophyton invades the keratins in the corneal layer of the skin surface, causing severe itching.
- Butenalock Vα Liquid is a therapeutic drug for athlete's foot/ringworm with excellent fungicidal effect on the pathogenic fungi in athlete's foot (Trichophyton).

Contains "Butenafine hydrochloride" with excellent fungicidal activity. Works on itchy athlete's foot!

- Penetrates well into the corneal layer and kills the pathogenic fungi in athlete's foot (Trichophyton).
- In addition to anti-itching ingredients, "Chlorpheniramine maleate", "Dibucaine hydrochloride", and "Crotamiton", l-menthol provides a cooling sensation to suppress itching.
- Contains a sterilizing ingredient "isopropyl methylphenol."
- Contains anti-inflammatory "glycyrrhetic acid."
- Due to excellent skin retention, this product works just by once daily usage.
- Rakunuri bottle

Example application of Butenalock Vα [Liquid]
(Also applicable to other symptoms.)

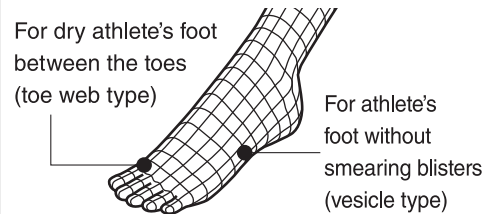

Benefits of Rakunuri bottle

"Rakunuri bottle" with a bent tip for easy application to the affected area on the toe.

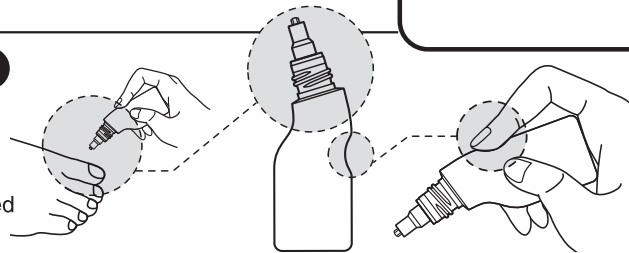

Dents in the bottom for stable handling.

⚠️ [Precautions]

❌ Do not use: [Failure to follow directions may result in worsening of current symptoms or cause side effects.]

1. Do not use:
 - if you have a history of allergic symptoms to this product or ingredients of this product.
2. Do not use this product on the following areas:
 - (1) Eyes and the surrounding area, mucous membranes (e.g., oral cavity, nasal cavity, and vagina), scrotum, and external genitalia.
 - (2) Eczema.
 - (3) Affected areas with severe infiltration, sores, cracks, or trauma.



Ask a doctor:

1. Ask a doctor, pharmacist, or registered distributor before use,
 - (1) If you are being treated by a doctor.
 - (2) If you are pregnant or possibly pregnant.
 - (3) Infants.
 - (4) If you have a history of allergic symptoms due to drugs.
 - (5) If the affected area is on the face or an extensive area.
 - (6) If the affected area is purulent.
 - (7) If you are not sure whether the cause is "Eczema" or "Tinea pedis, tinea cruris, or tinea corporis" (If the symptom is itch/sore in the scrotum, it is usually caused by eczema.)
2. If the following symptoms appear after use, there may be side effects. Stop using this product immediately, and ask a doctor, pharmacist, or registered distributor within this information leaflet.

Related area	Symptoms
Skin	Rash/redness, itching, eruption, swelling, irritation, warmth, skin shedding, sores, blisters, dryness, sting, cracks

3. If the symptoms persist after 2 weeks of use, stop using the product and ask a doctor, pharmacist, or registered distributor within this information leaflet.

[Indications] Tinea pedis, tinea cruris, and tinea corporis

[Dosage and usage] Apply a proper amount to the affected area once daily.

<Precautions related to dosage and usage>

- (1) Do not use when the affected area and the surrounding are not clean.
- (2) Avoid contact with the eyes. If eye contact occurs, rinse immediately with water or warm water and consult an ophthalmologist right away.
- (3) Children should use this product only under adult supervision.
- (4) For external use only.

[Ingredients/contents]

Active ingredients	Content (per 1 mL):
Butenafine hydrochloride	10mg
Dibucaine hydrochloride	2mg
Chlorpheniramine maleate	5mg
Glycyrrhetic acid	2mg

Active ingredients	Content (per 1 mL):
l-menthol	20mg
Crotamiton	10mg
Isopropyl methylphenol	3mg

Inactive ingredients: Ethanol, macrogol

<Precautions regarding the ingredients>

It contains alcohol and may sting the skin during application.

Precautions for storage and handling

- (1) Store in a cool place with lid closed tightly, away from direct sunlight.
- (2) Keep out of reach of children.
- (3) Avoid storing the product in other containers (it may result in a misuse or a change in quality).
- (4) Do not use the product after the expiration date. Also, use as soon as possible after opening the package even if the expiration date has not passed for ensuring the quality.
- (5) Keep away from fire and do not place the product in fire. Also, the container should not be thrown into fire after use.
- (6) This product may soften synthetic resins (styrol) or dissolve paint. Make sure that this product does not come into contact with bags, floors, or furnitures.



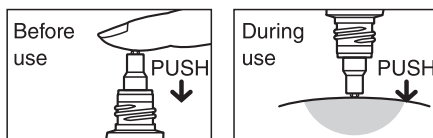

<Packaging> 18mL

[How to use the container]

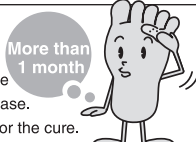

- Point the tip of the container upward and push the container with fingertips to remove the air from inside before use. (To prevent the drug solution from coming out too much, due to increased internal pressure during hot season.)
- For application to the affected area, point the container downward or diagonally and press the tip lightly against the affected area. (Drug solution will not come out when the tip is away from the affected area.)

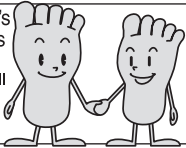
5 tips for the treatment of athlete's foot

<p>1 Always ensure that your feet are not sweating.</p> <p>Trichophyton multiplies when the temperature is 15°C and above, with humidity of 70% or more. Always prevent sweating and try to keep your feet dry.</p> 	<p>4 Continue to apply the medicine to the athlete's foot for at least 1 month even after symptoms disappear.</p> <p>Even if symptoms disappear, it may be that only the activity of Trichophyton is suppressed, not the disease. Be patient, for continuous application is essential for the cure.</p> 
<p>2 Keep the affected area clean. It is important to wash the affected area with soap everyday.</p> <p>Although this product is effective if used once daily, it is important to take appropriate long-term measures such as avoiding sweating and keeping the shoes and socks clean (frequent washing).</p> 	<p>5 If one of the family members has athlete's foot, it is recommended that all members of the family should also be treated. If one of the family members has athlete's foot, it will pass on to the others. Take a treatment as soon as possible if you notice a symptom.</p> 
<p>3 Apply the drug thinly, not only to the affected area but also to the surrounding area.</p> <p>Apply the drug extensively because the area of infection of Trichophyton is often wider than the area with symptoms.</p> 	<p>Daily comprehensive foot care is important for the cure of athlete's foot.</p>